



68



---

PRELIMINARY PRESENTATION

NEW AZIMUT 68

# A yacht for the world

*with a choice of layouts to suit every lifestyle*

A sleek flybridge yacht, made with extensive use of carbon fiber, refined interiors and a clever layout.

The new Azimut 68 raises the bar even higher, conceived to capture interest around the world by letting you decide the way you prefer to spend time onboard.

It offers the owner the choice of three possible Main Deck configurations, plus a multifunctional area, each with a particular lifestyle in mind.

















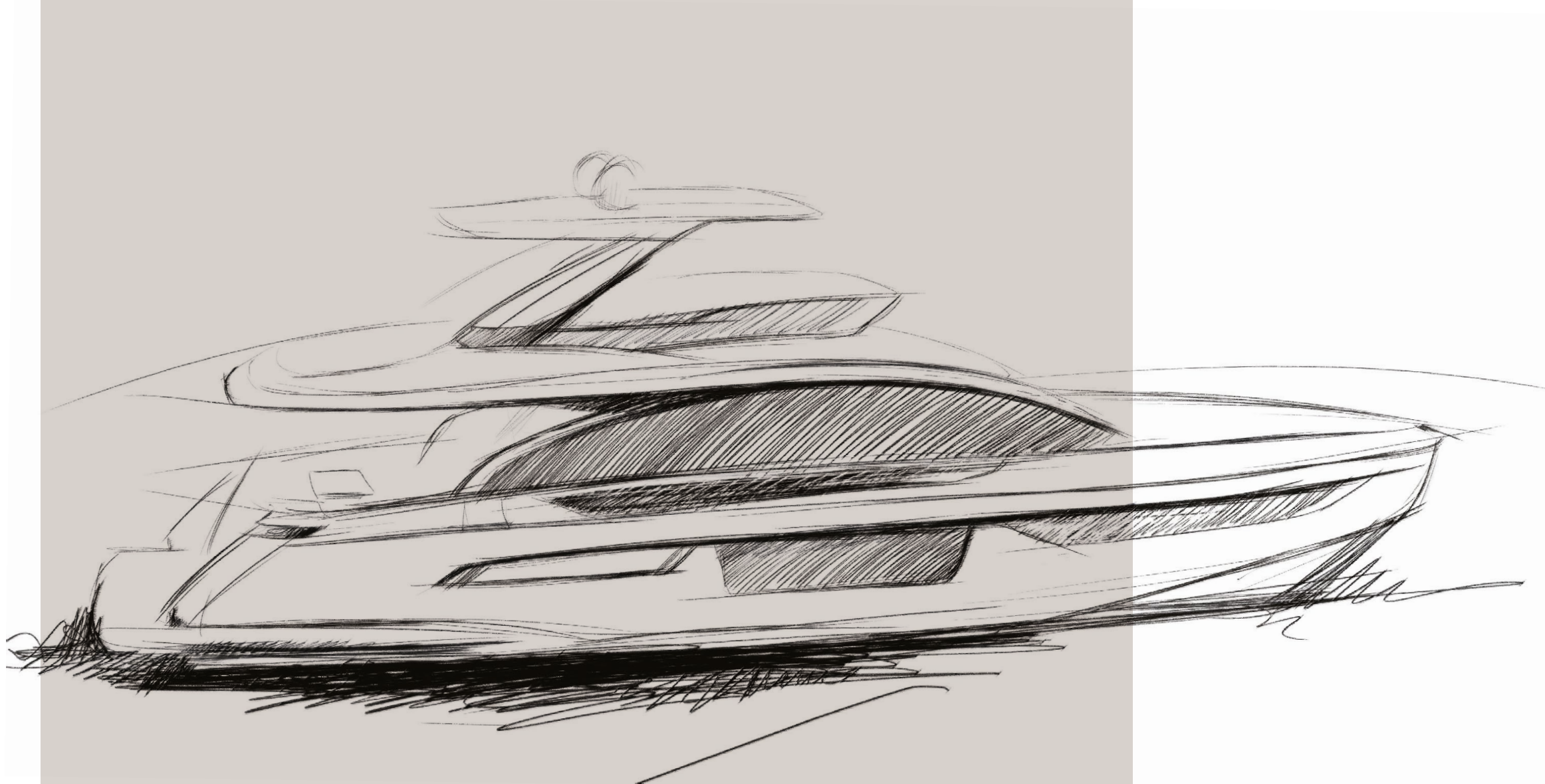

## EXTERIOR DESIGN BY **ALBERTO MANCINI**



The exteriors have been designed by Alberto Mancini, an eclectic talent able to successfully blend automotive inspirations with genuine nautical elements.

His extraordinary capacity to create designs that articulate a truly innovative yachting language make him the ideal partner to interpret Azimut's vision for yachts that continue to push the bar. His background in the automotive industry has seen him introduce a soft yet dynamic touch to the yachts he designs, without ever losing sight of the brand's DNA.







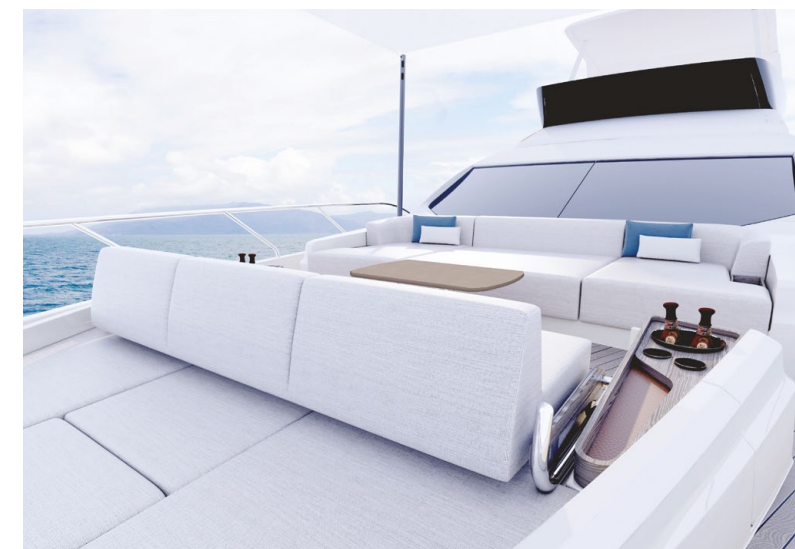



# THE FLYBRIDGE LET THE BEAUTY SURROUND YOU



Everything on Azimut 68 is amplified: abundant space and unparalleled liveability offered. Three separate areas make this the ideal place to enjoy unique experiences in complete freedom and privacy.









For either a quick lunch at anchor or a slap-up dinner against the backdrop of a spectacular crimson sunset... the cockpit area is the perfect place to enjoy unique moments in the company of your guests.





# A LAYOUT FOR EVERY LIFESTYLE

With a choice of three main deck layouts and a multi-functional zone, the Azimut 68 is the epitome of a true “world yacht”.

The starting point for its design was a comprehensive analysis of all the various ways owners and guests pass their time on board, taking into account variations in lifestyle habits and preferences across different markets.

The result is yet more freedom, but this time, the freedom of boat owners to choose the layout that best reflects their idea of how to make the most of their onboard experiences.

## ENCLOSED GALLEY LAYOUT

An elegant living area is located in the entrance area of the main deck, with the galley tucked away behind an innovative combination of ribbed wood and plexiglass. This solution, called Lanterna, closes the galley off to create privacy, but enables the light to flow through the entire space for a luminous, spacious environment.

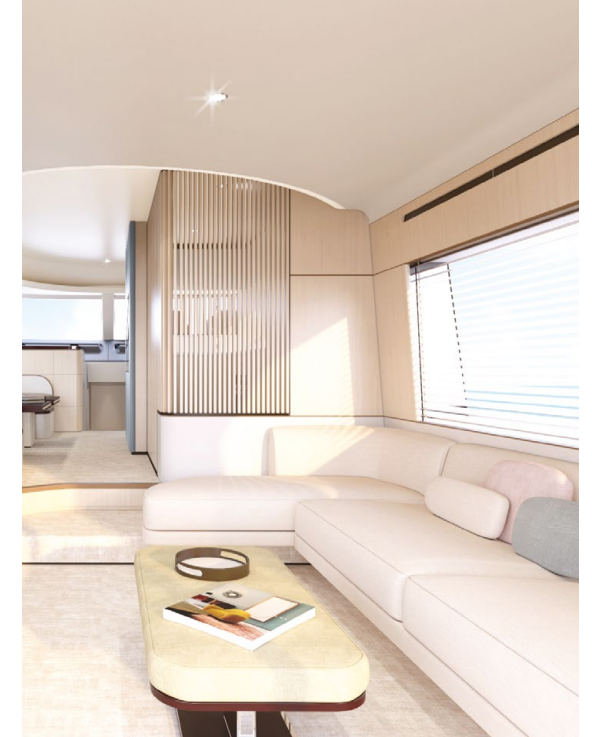

## OPEN GALLEY LAYOUT

For owners who are seeking a more convivial layout, this option, also situated in the bow, is the ideal solution. The galley is in a discreet location, but opens directly into the dining area, which can also be converted to a second lounge zone.



## AFT GALLEY LAYOUT

This layout is slightly more informal, with the galley located in the stern and the dining room situated immediately as you enter from the cockpit, for a relaxed indoor-outdoor flow, while the living room is moved towards the bow.







# INTERIOR DESIGN BY **ACHILLE SALVAGNI**



The interiors have been designed by Achille Salvagni, a Roman architect, designer and artist.

AD Collector's listed Achille Salvagni between the 100 most influential designers of our century.

His unique stylistic language, which draws on Roman classicism on one hand and sleek sophisticated Scandinavian design principles on the other, has stamped its distinctive mark on the interiors of several recent models of our Flybridge and Grande collections.

**ACHILLE SALVAGNI**  
ARCHITETTI





View of the main deck in the Enclosed Galley Layout version

SALON MAXIMUM HEIGHT: 2.20 METERS (7' 3")





Throughout the yacht, warm, natural colours and beautiful, quality materials combine to create a welcoming, harmonious environment.  
Matt-finished Thai wood combines with inserts in natural teak and pale matt painted surfaces, creating gentle, fluid lines that link the various spaces.  
Details in glossy mahogany wood add a touch of elegant contrast for a stylish, fresh and airy look.





Located towards the prow on the main deck, the dining zone can also function as a lounge area through the option of a dining table that instantly transforms into a pair of coffee tables. This area can also be accessorised with a television set built into the kitchen partition. While the standard design sees the kitchen as part of an open plan layout, a variation in which it is closed off is available, offering greater privacy through a slatted partition. Whilst providing a physical separation, the fluidity of the entire area is maintained, with the light flooding the entire space from prow to stern, and filtering through the slats in a delicate and original “lantern” effect.

DINETTE AND GALLEY MAXIMUM HEIGHT: 2 METERS (6' 7")





View of the main deck in the Open Galley Layout version



View of the Enclosed Galley Layout version



View of the Open Galley Layout version





View of the Aft Galley Layout version





View of the Aft Galley Layout version



# THE **ART** OF HOSPITALITY



The elegant, original atmosphere of the interiors stems from the soft, curved lines synonymous with designer Achille Salvagni's approach. The charm of these spaces reflects his philosophy of creating flowing, contemporary dynamics, free from uninviting sharp, straight edges.





A light architectural touch frames the wonder of the sea. Each element flows seamlessly into the next, with a complete absence of sharp angles and edges. The colours unfold softly and naturally to create a serene, refined atmosphere. The ensuite bathroom of the owner's cabin features a sliding door that can be fully rolled back to create a stylish spa effect.

OWNER'S SUITE MAXIMUM HEIGHT: 1,95 METERS (6' 5")





The night area in the Azimut 68 is surprisingly generous with space, offering four cabins served by three bathrooms with separate shower. In the bow, the VIP cabin offers guests the utmost in comfort and liveability, with big windows, fine detailing and extensive storage space.

VIP CABIN MAXIMUM HEIGHT: 1,95 METERS (6' 5")









GUESTS CABIN MAXIMUN HEIGHT: 1,95 METERS (6' 5")













# CARBON-TECH GENERATION

Azimut Yachts is a pioneer in the extended use of carbon fibre, introducing it across all its collections and understanding its potential in terms of enhanced performance on the water and unprecedented on-board comfort. The use of carbon fibre not only enables increased volumes and additional surfaces within the same weight ranges, but also delivers outstanding levels of both static and dynamic stability, with a decrease in roll momentum of between 3 and 15%. The Azimut 68 uses pure carbon fibre laminated with vynilester resin on its deck, flybridge, hard top.

Flybridge	
Radar arch	
Hard top	 *
Hull	
Deck	
<div><div> Carbon Fiber</div><div> Hybrid Carbon Glass</div></div> <div>*optional</div>	



Reflecting Azimut Yachts' commitment to providing boat owners with the most advanced and high-performance boating technology available, the **Azimut 68** is powered by twin **Volvo Penta IPSs**.

Understanding the extraordinary potential of this highly efficient **Integrated Propulsion System**, members of the Azimut Yachts Innovation Lab spent time with **Volvo Penta engineers** to gain more indepth knowledge of how hull design could be optimised to best incorporate it. The results can be seen in a number of benefits in the Azimut 68:

- Reduced vibrations, noise and total weight
- The combination of IPS and the ample use of carbon fibre throughout the yacht delivers a significant reduction in fuel consumption, representing a responsible environmental choice
- More onboard living space as the compact design means a smaller engine room, to the advantage of the accommodation area

Manoeuvring becomes even easier with the optional installation of **Assisted Docking**, the brand-new **Volvo technological solution** that is set to revolutionise the berthing process.

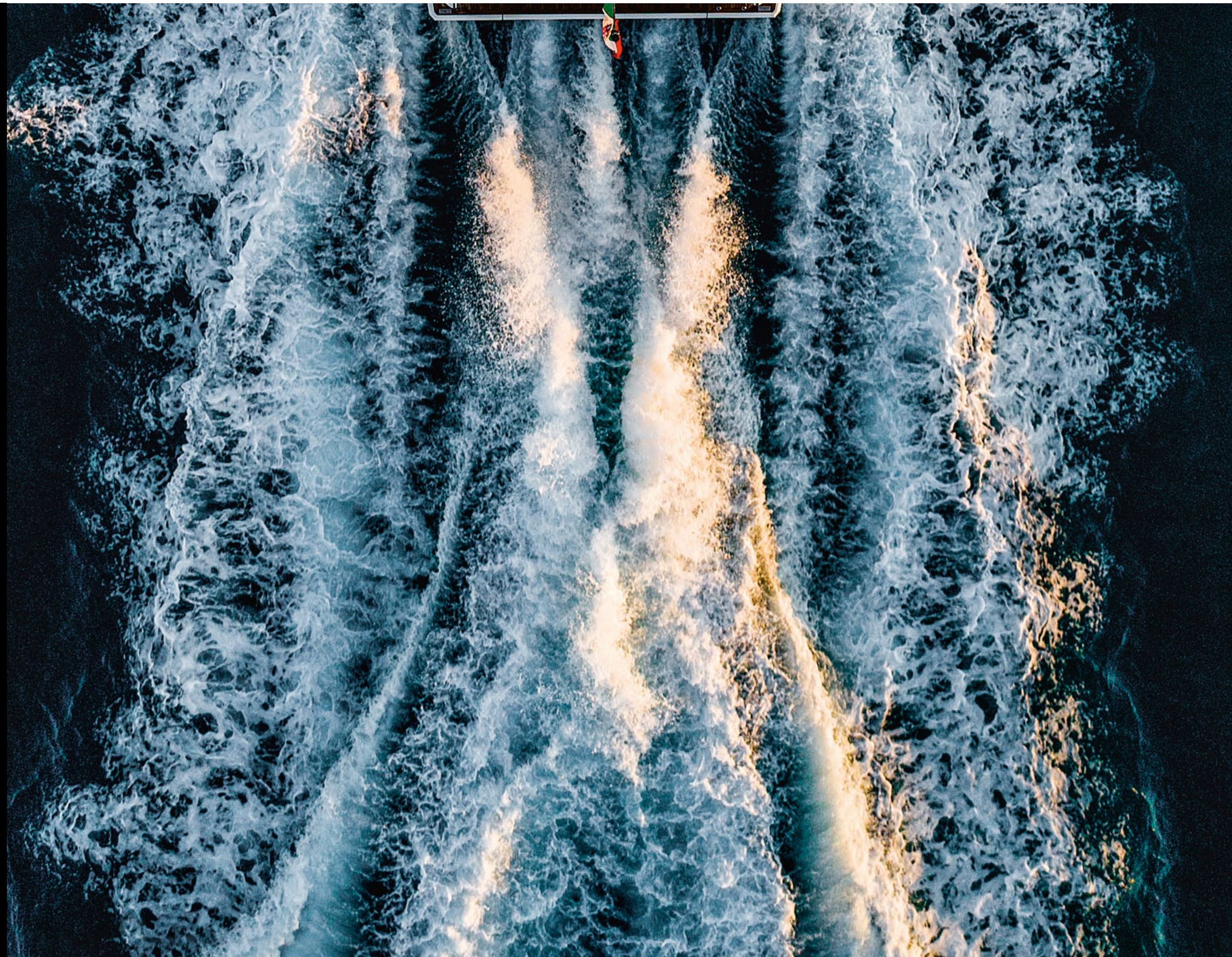



# MAIN PROJECT DATA

## AZIMUT 68

Length overall (incl. pulpit)	20,98 m (68' 10")
Beam max	5,23 m (17' 2")
Draft (incl. props at full load)	1,60 m (5' 3")
Displacement (at full load)	43,7 t (96342 lb)
Engines	2 X VOLVO IPS 1350 (1000 HP)
Maximum speed	up to 32 knots
Cruising speed	28 knots
Fuel capacity	3.700 l (977.4 US Gal)
Water capacity	1.000 l (264.2 US Gal)
Max persons	14
Exterior styling & concept	Alberto Mancini
Interior Designer	Achille Salvagni Architetti
Hull designer	P.L. AUSONIO Naval Architecture & Azimut R&D Dept.
Builder	Azimut Yachts
CE category	A

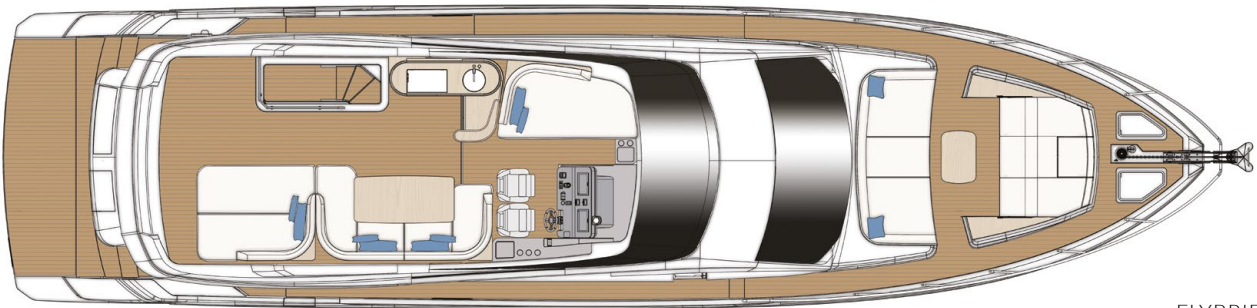

FLYBRIDGE

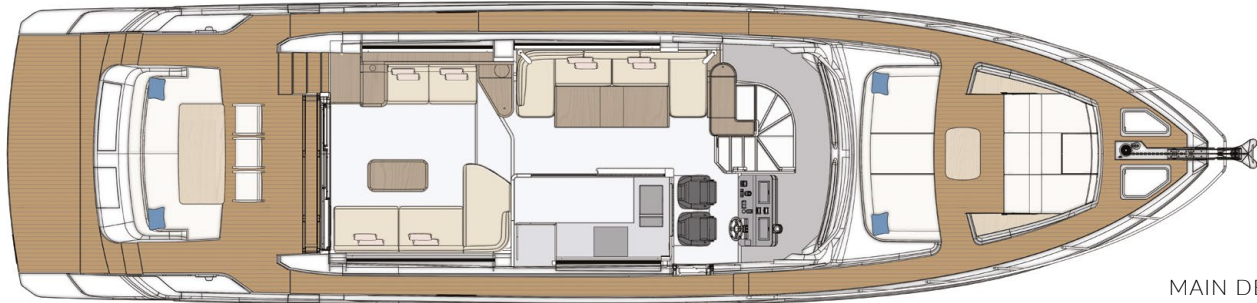

MAIN DECK  
ENCLOSED GALLEY LAYOUT

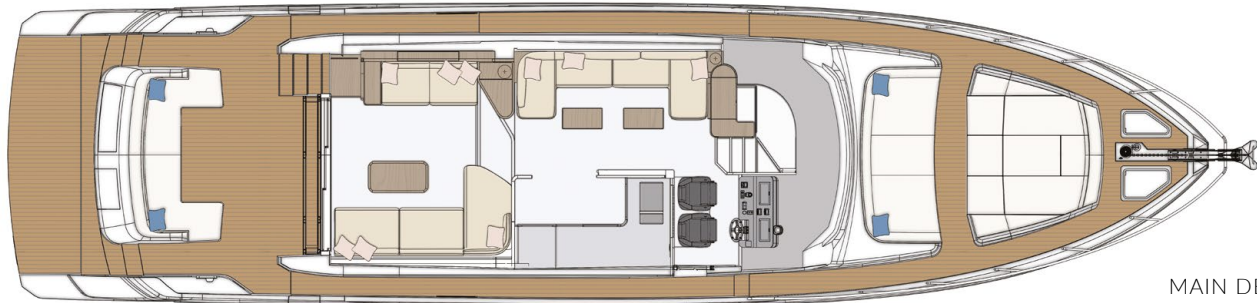

MAIN DECK  
OPEN GALLEY LAYOUT

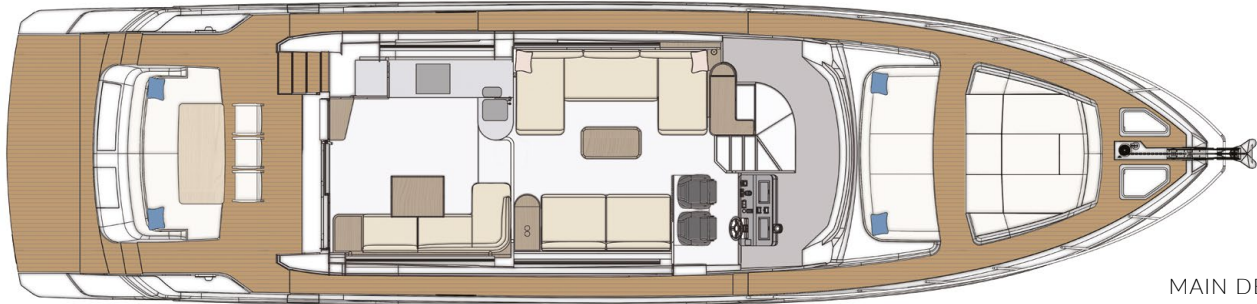

MAIN DECK  
AFT GALLEY LAYOUT

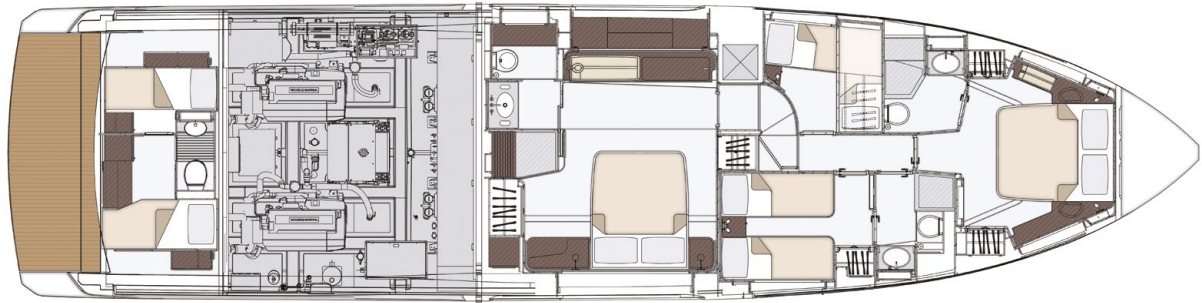

LOWER DECK

68





68  
AZIMUTYACHTS.COM

This brochure in no way constitutes a contract of sale for the boatyard's vessels to any person or company. All information contained herein, including but not limited to technical and performance data, illustrations, and drawings, is non-binding and for purposes of illustration only. The information in this brochure refers to the boatyard's standard motoryacht models available as of the date of publication. Technical and descriptive information is valid only to the extent that it pertains to the specific vessel that is the subject of a purchase. Contract terms are valid only to the extent that they are contained in a contract of sale. This document is based on information available at the time of publication. Despite efforts to ensure the greatest possible accuracy, the information contained herein may fail to cover all details, omit technical or commercial changes that may have been made subsequent to publication, describe features that are not present, and fail to envisage all circumstances that might occur. Any illustrations, photographs, diagrams and examples shown in this brochure are included solely for the purposes of illustrating the text. Due to the different features of each vessel, the boatyard assumes no liability for actual use based on the illustrated applications.